

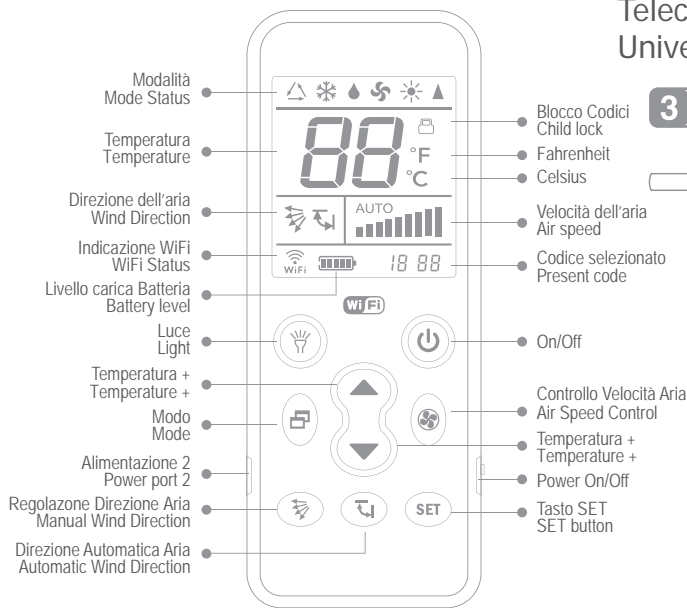

1

Telecomando universale per condizionatori Universal air conditioner remote control



3 Collegare il cavo di alimentazione alla presa di corrente.
Plug the power adaptor into the power outlet.

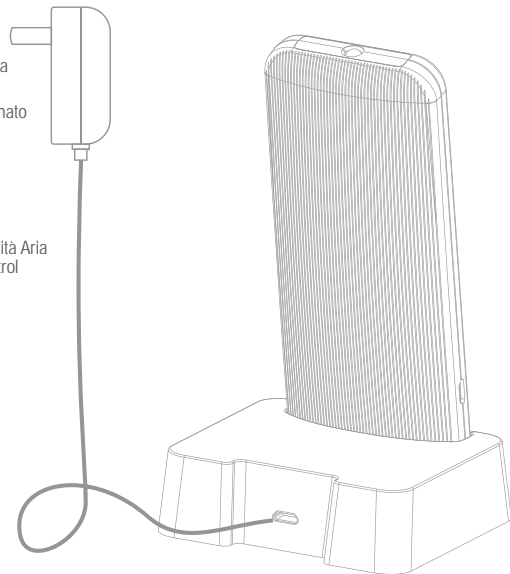

1 Posizionare il telecomando sulla base di alimentazione.
Place the remote control on the power base.

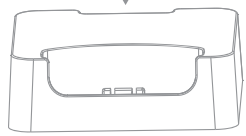

2 Collegare il cavo di alimentazione alla base.
Plug the power cord into the base power inlet.



Per caricare il telecomando - To charge the remote control
 Accendere il telecomando con il cursore sul lato destro e collegare il cavo di alimentazione alla base per caricare la batteria.
 Please switch on the Power on the right side of the remote control and connect the power cord according to the above diagram to charge the battery.

SETTING REMOTE CONTROL

The remote control can be set to 3 different modes. Choose mode 1 if the brand of your air conditioner is among those in the image below, or modes 2 or 3 for all other brands.

1 POINT-TO-POINT QUICK BRAND SEARCH

1. Power on the A/C manually and point the remote control at the A/C receiver window.
2. Press and hold the button corresponding to your brand, (e.g., LG corresponds to "Temp ▲") until the A/C makes a "beep" sound and automatically switches on, and then immediately release the button.
3. Test if the buttons function normally. If yes, complete the setting, if not, repeat Step 2.

Corresponding button and brand table

Temperature +	Temperature -	Mode
LG/Samsung/Chunlan/Aux	Midea/Changhong/TCL/Shinco/Aucma	Gree/Hualing/Chigo/Hisense/Kelon
Air Speed Control	Automatic Wind Direction	Manual Wind Direction
Daikin/Fujitsu/Carrier	Sanyo/Sharp/Frestech/Y Air	Hitachi/Panasonic/Haier/Mitsubishi

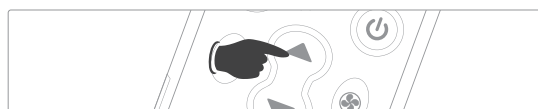

2 MANUAL CODE ENTRY

1. Connected to www.wellclima.com website, find air conditioner brand in the 'CODE LIST' of SMART model and check the first set of codes.
2. Press and hold SET button, then press POWER button and hold them down. Release the two buttons when the model code flashes on the screen window (bottom right). Press "TEMP ▲" or "TEMP ▼" until the code found in Step 1 appears on the screen window (you can keep the TEMP keys pressed to scroll the codes faster).

LENNOX	000, 020-039
LENVANTE	040-059
LG	600-609
LIKEMAR	105-107
LITTLEDUCK	454-456
LITTLESWAN	344
	861



3. Press the SET button to exit, check the button functions. If the device respond correctly the setting is finished, if not, please repeat steps 2 and 3 with next set of codes.

LOOK OUT: when the codes are separated by a - sign it means all the numbers between the first and the last (es LG 600-609 you have to test codes 600, 601, 602...>609). If none of the codes work with your air conditioner or if your brand is not in the list don't worry, proceed with the Automatic Code Search.

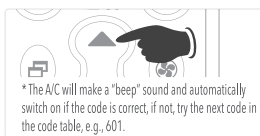

* The A/C will make a "beep" sound and automatically switch on if the code is correct, if not, try the next code in the code table, e.g., 601.

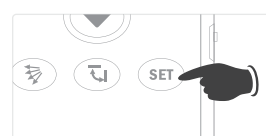

3 AUTOMATIC CODE SEARCH

1. Aim the remote towards the air conditioner receiver window.
2. Press and hold SET button, about 6 seconds later the model code (bottom right) starts to flash, do not release the button until the air conditioner switches on automatically.



3. Release the SET button immediately when the conditioner turns on and check the button functions. If the buttons work correctly, the code setting is effective. If not, please repeat steps 2 and 3.
4. A complete scan of all codes takes about 30 minutes. Do not stop the search before, or before the air conditioner switches on.



CHILD LOCK FUNCTION

To lock: Press and hold the "SET" and "Manual Wind Direction" buttons at the same time until the screen displays the child lock icon. This means the child lock is operational. Release the buttons.

! When locked, code search and other settings will not work, however the remote control functions normally.

To unlock: Press and hold the "SET" and "Manual Wind Direction" buttons at the same time until the child lock icon disappears from the screen. The control is now unlocked.

TO RESTORE TO FACTORY SETTINGS

Press and hold "SET" + "Air Speed Control" buttons at the same time. The screen will display all the information after about

- 3s. Release the buttons to successfully restore the factory settings.

ATTENTION



You must point the remote control at the A/C receiver window.

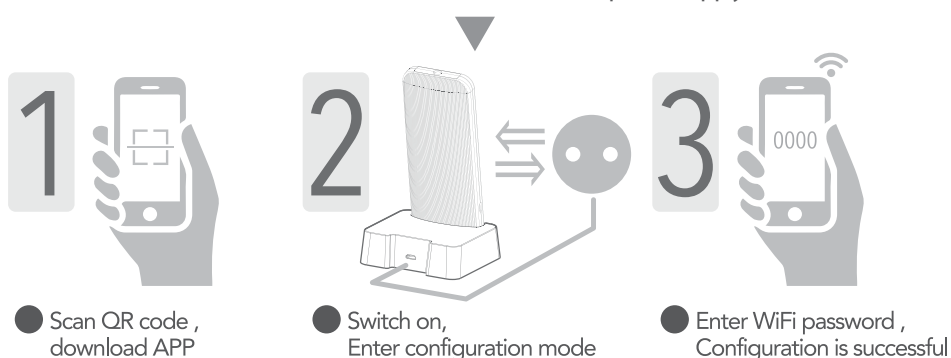

DOWNLOAD AND INSTALL THE REMOTE CONTROL APP

We use the **Genius Remote** app to manage the remote control by smartphone. Remember that the SMART remote control connects to the Wi-Fi network when it is placed in its own base and / or connected to the power supply.



1. Find "Genius Remote" in the App Store or in Google Play or scan the QR code to download and install the app.
2. Register your account in the Welcome screen (REGISTER link at the bottom right).
3. Choose your account name and password, enter your email address and register. The e-mail address is only for password recovery.
4. Make sure that your mobile phone is connected to the Wi-Fi network and connect the remote control to the power supply base.
5. Tap on Add Device > A/C Remote Control.
6. Press and hold the remote control "On/Off" button (⏻) (for about 5s) and release it when  appears on the screen. After some time, the Wi-Fi icon () will flash rapidly (bottom left), and the remote control will enter the configuration mode.
7. At the next step you should see the name of your network. Enter the network password and touch [configuration]. After a few seconds the remote control code will appear with the word ON LINE on. If you want to change and customize the name of the remote control, tap on EDIT. To enter the screen, tap on the name of the remote control, now you can control the air conditioner with the APP.
8. **TIMER** - Entering the TIMER function and touching the + (top right) it is possible to add different ON / OFF programs for each day of the week.



Q: Cannot configure or no response during the configuration?

A: Please check if the Wi-Fi router can access the network. Please place the remote control into the power supply base; the remote control can be only used as a universal remote control if it is not placed into the power supply base; Wi-Fi remote control function is available only after the remote control is placed into the power supply base.

Q: Failed-Config?

A: Please check the router Wi-Fi signal strength and if network speed is normal, then try to reconfigure. Please place the remote control into the power supply base, and check if the remote control screen displays Wi-Fi icon.

Q: Cannot control the A/C with remote control after successful configuration?

A: Please set the code on the remote control again. Confirm that the remote control can control the A/C and that the code displayed in the remote control matches with that displayed in the APP (lower left). If not work you may need to set the remote control again;

Q: The APP displays device offline?

A: Please place the remote control into the power supply base, and check if the remote control screen displays Wi-Fi icon (). Please check if the connected Wi-Fi router works normally.

Q: How can you know if the remote control is successfully connected to Wi-Fi?

A: The APP will display device online and the Wi-Fi icon () on the remote control screen will stay on when the remote control successfully connects to the Wi-Fi router. Wi-Fi function will be automatically disabled (Wi-Fi icon on remote control screen will disappear) when the remote control is disconnected from the power supply base. Wi-F function will be automatically enabled (Wi-Fi icon on remote control screen will appear) when the remote control is connected to the power supply base.

Q: Can the SMART remote control work without the power supply station?

A: The SMART remote control can control the air conditioner without using the support base, but it connects to the wi-fi network (and to your smartphone) only when it is powered by the base. If you have difficulty placing the base in a suitable position or want to use another support type, you can insert the charger micro usb connector directly on the left side of the SMART remote control.

Q: How long is the automatic code search?

A: it depends on the air conditioner brand and model, often just a few minutes are needed, but a full scan of all the codes takes about 30 minutes. Do not stop the search before or before the air conditioner turns on.

Tips:

- After replacing the router or restoring the router to factory settings, you must reconfigure the device by following the Add device step on the APP.
- 1-3s delay during remote control operation by mobile phone is normal. If there is a prolonged delay or there is no response, please test if the Wi-R network connection speed of the mobile phone and router are normal.
- You must point the remote control at the A/C receiver window.
- Please do not disassemble the remote control by yourself or throw it in fire as it has an inbuilt lithium battery.
- Please keep the remote control away from heat and fire, and please do not let children use the charger without adult supervision, as there may be potential safety hazards.
- It is recommended to charge with ambient temperature below 40°CThe battery will slightly heat up when fully charged, which is normal.
- Please switch off the Power on the right side of the remote control if you do not plan to use the remote control for a long time.

This remote control is compatible with 99% of brand of air conditioners, we perform compatibility tests with the various brands and the codes are constantly updated. It can operate only if the air conditioner receiver works well. To check if the new remote works (or even the old one) we suggest you to do this test: frame the led that you find on the top edge with a digital camera or a smartphone (not iphone), press the on-off button several times, through the camera you will see the LED light up slightly. If the led turns on the remote control transmits, if you have tried the various setup methods and the air conditioner has never turned on it is probable that the problem is in the receiver inside the control unit, in this case you must contact the service. If you find any other problems or remote control cannot be used appropriately, please visit HELP and FAQs page on our website www.welclima.com or contact us and we will provide our best service for you.

IT

Puoi visualizzare o scaricare le istruzioni in Italiano di questo prodotto all'indirizzo: <https://wellclima.com/manuali/> o con la scansione di questo QRcode

**EN**

You can view or download english instructions for this product at: <https://wellclima.com/en/manuals/> or by scanning this QR code

FR

Vous pouvez afficher ou télécharger les instructions en français concernant ce produit à l'adresse suivante: <https://wellclima.com/fr/manuels/> ou en scannant ce QRcode

**ES**

Puedes visualizar o descargar las instrucciones en español de este producto en la dirección: <https://wellclima.com/es/manuales/> o con el barrido de este QRcode

DE

Eine Anleitung in deutscher Sprache zu diesem Produkt können Sie unter der folgenden Adresse: <https://wellclima.com/de/handbuecher/> oder durch Scannen dieses QR-Codes einsehen oder herunterladen



Ai sensi della direttiva 2012/19/EU D.L. N°49/2014 Multiservizi (proprietaria del marchio wellclima) in qualità di fornitore del prodotto da la seguente informativa: è fatto obbligo di non smaltire i RAEE come rifiuti urbani e di effettuare una raccolta separata. Alla riconsegna dell'apparecchio per l'acquisto di uno nuovo il produttore stesso provvederà al reimpiego, riciclaggio od altre forme di recupero a mezzo delle misure adottate dalla pubblica amministrazione. Tale informativa è data al fine di evitare gli effetti potenziali sull'ambiente e sulla salute umana dovuti alla presenza di sostanze pericolose nelle apparecchiature elettroniche o ad un uso improprio delle stesse; pertanto ogni apparecchio venduto è soggetto alla presente informativa e sarà contrassegnato dai simboli sotto indicati.

In compliance with directive 2012/19/EU D.L. N°49/2014 Multiservizi (owner of wellclima brand) being the suppliers of this products issues the following information: it is mandatory not to dispose of the RAEE as if they were urban waste, but to carry out a separate collection of them. When delivering the equipment upon purchase of a new one, the same manufacturer shall provide in re-using, recycling it or other forms of recycle through measures implemented and approved by the public administrations. Such information is supplied in order to prevent potential effects on the environment and human health due to the presence of dangerous substances in electronic equipments or due to an improper use of the same. Therefore every electronic equipment sold shall subject to this directive and shall be marked with the symbol shown here below.



Tutti i diritti riservati - Copyright Multiservizi
Vietata la riproduzione parziale o totale di questo manuale.
Importato da Multiservizi - Capriano del Colle - BS - Italy
Disegni ed informazioni possono variare senza preavviso.

All rights reserved - Copyright Multiservizi
Unauthorized reproduction of all or part of this guide are prohibited.
Imported by Multiservizi - Capriano del Colle - BS - Italy
Design and technical parameters may vary without notice.